

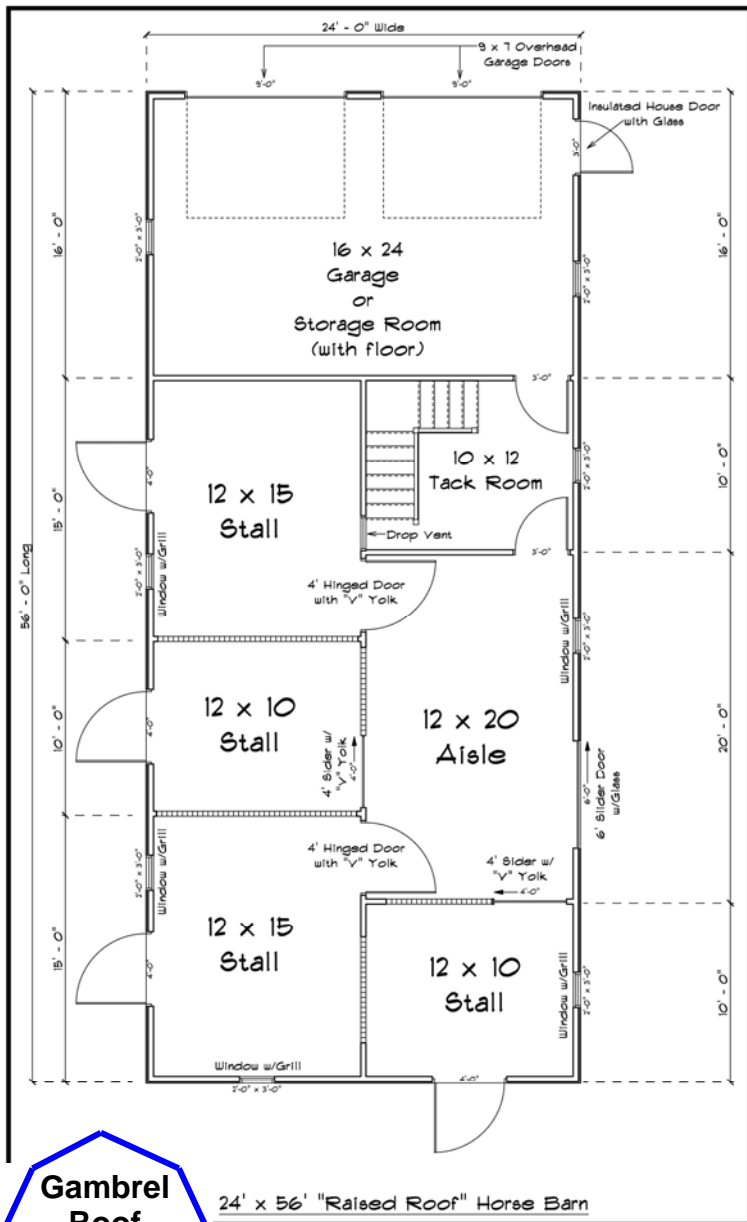

The Shire 4 Stall with Garage, 24 x 56



**Gambrel
Roof
Available
ADD
\$ 3895**
*Loft Model Only

STANDARD FEATURES:

Stalls Include:

- 4' x 7' Sliding Stall Door (10 x 12 Stalls) - 4 door styles to choose from
- Powder-Coated Steel Grill Stall Front with Chew Guard (10 x 12 stalls)
- 4' x 7' Hinged Door (12 x 15 Stalls) -
- 2' x 3' Drop Vent - 12 x 15 stall
- Stall Partition - grill or solid wall: *YOUR CHOICE*
- 4' High Solid OAK Kickboard
- 2' x 3' Window with Grill (except for 12 x 10 "center" stall)
- 4' x 7' Dutch Door with Chew Guard - Allows access from outside the barn

Barn Interior (lower level):

- 2' x 8' Tongue & Groove in Aisle
- 2' x 3' Window with Grill
- Tack Room with 5/8" Plywood Floor, 2 Wood Doors and 2' x 3" Window
- Full Wooden Staircase with Rail
- 6' x 7' Sliding Barn Door with Windows

Loft - 8' Overhead Clearance:

- 5/8" Plywood Floor
- 3' x 6' Hay Door on Gable End
- 2 - 2' x 3' Windows Opposite Gable End
- 32" x 32" Hinged Trap Door
- 7'6" Overhead Clearance

Construction Details:

- Pressure-Treated 6x6 Foundation Sills
- 1/2" Smart Panel Wood Siding™
- Exterior Paint - *You choose siding and trim color*
- 10' Side Walls
- Wall Studs: 2x4, 16" on center
- Floor Joist: 2x6, 16" on center
- Rafters: 2x6, 24" on center
- Perlins: 2x4, 24" on center
- 30 Year Architectural Shingle - *You choose color*
- 8" Overhang on Gables
- Shutters Included Windows - Wooden "Z" Style or Vinyl - *Your choice*
- Steel Reinforced Corners with Built-In Tow Hooks
- Gable Vents

Garage:

- 2 - 9' x 7' Overhead Garage Doors
- 3' x 6' Insulated House Door with Window
- 2 - 2' x 3' Window
- 5/8" Reinforced Plywood Floor